

**INVICTA**

**Foyer OPTI GV AVEC VOILET**

Référence P677075

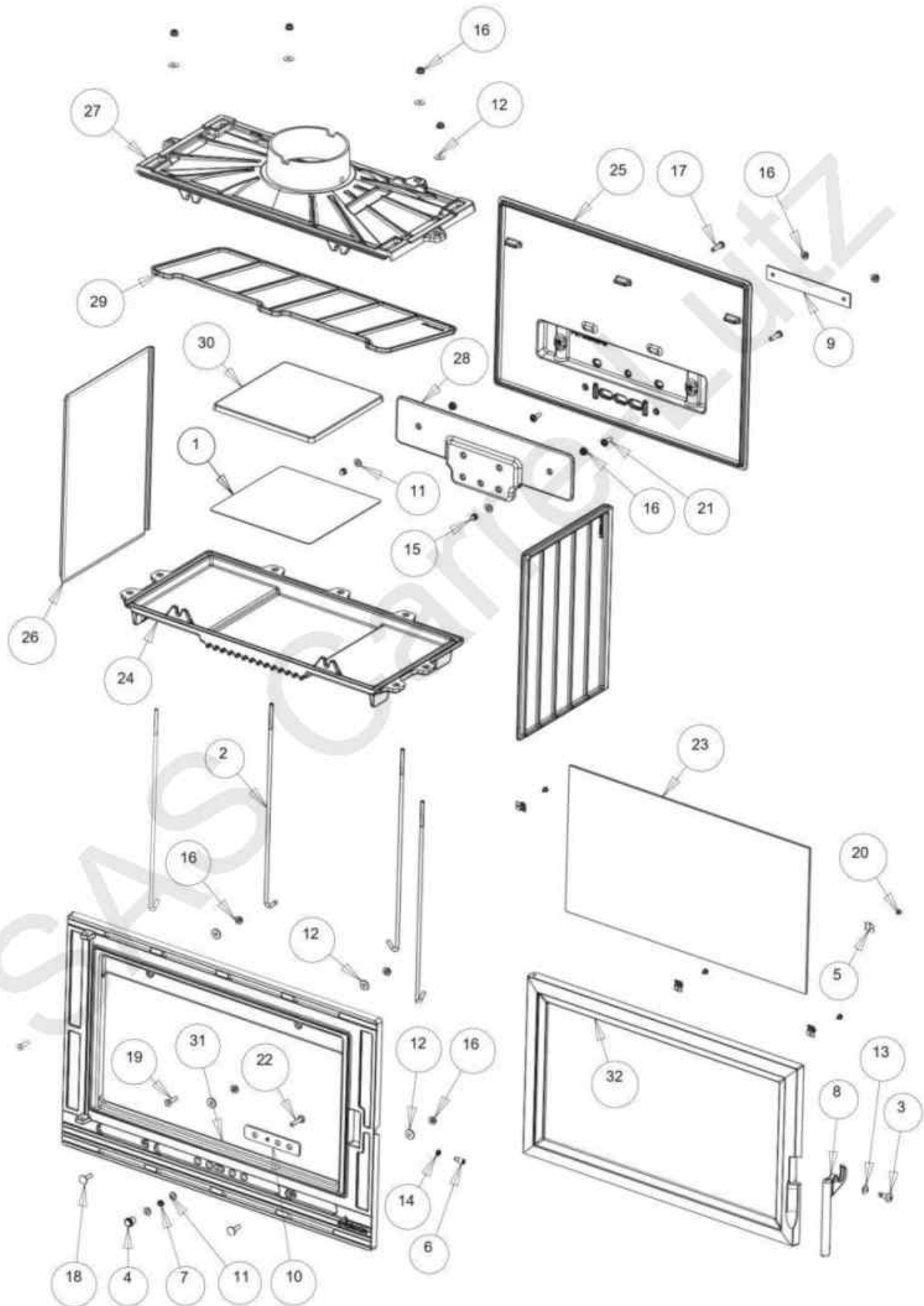

**Foyer OPTI GV AVEC VOLET**

Référence P677075

REP.	QTE	DESIGNATIONS	REFERENCES
	1	JOINT PORTE THERMOCORDE Ø 9 mm Lg 2.0 m	AI303009
	1	JOINT VITRE THERMOCORDE 7x3 mm Lg 1.7 m	AI010080
1	1	PLAQUE SIGNALETIQUE	AM677174
2	4	TIRANT	AS049010
3	1	VIS LOQUET	AS610315
4	1	BOUTON ALU	AS610318
5	4	CLAMS	AS700180
6	1	EXCENTRIQUE FERMETURE	AS700253
7	1	RESSORT REGISTRE	AS700308
8	1	LOQUET	AS800300
9	1	OBTURATEUR	AT700160
10	1	REGISTRE	AT700363
11	4	RONDELLE M M06	AV4100060
12	8	RONDELLE L M6	AV4110060
13	1	RONDELLE ONDULEE D8	AV4170081
14	1	ECROU H M6	AV7130060
15	2	ECROU BORGNE M6	AV7140060
16	12	ECROU EMBASE M6	AV7220060
17	2	VIS TH M6x25	AV8406250
18	2	VIS TRCC M6x30 INOX	AV8476306
19	2	VIS FHC M06x25	AV8636250
20	4	VIS TCPZ M04x06 ZING	AV8644067
21	2	VIS TBEHC M6x20	AV8696200
22	1	VIS TBEHC M6x30	AV8696300
23	1	VITRE	AX677075
24	1	SOCLE	F670695B
25	1	FOND	F670696B
26	2	COTE	F670697B
27	1	AVALOIR	F670699B
28	1	TAQUE	F670701B
29	1	DEFLECTEUR	F670702B
30	1	PLAQUE FEU	F670703B
31	1	FACADE	F670717U
32	1	PORTE	F670718U

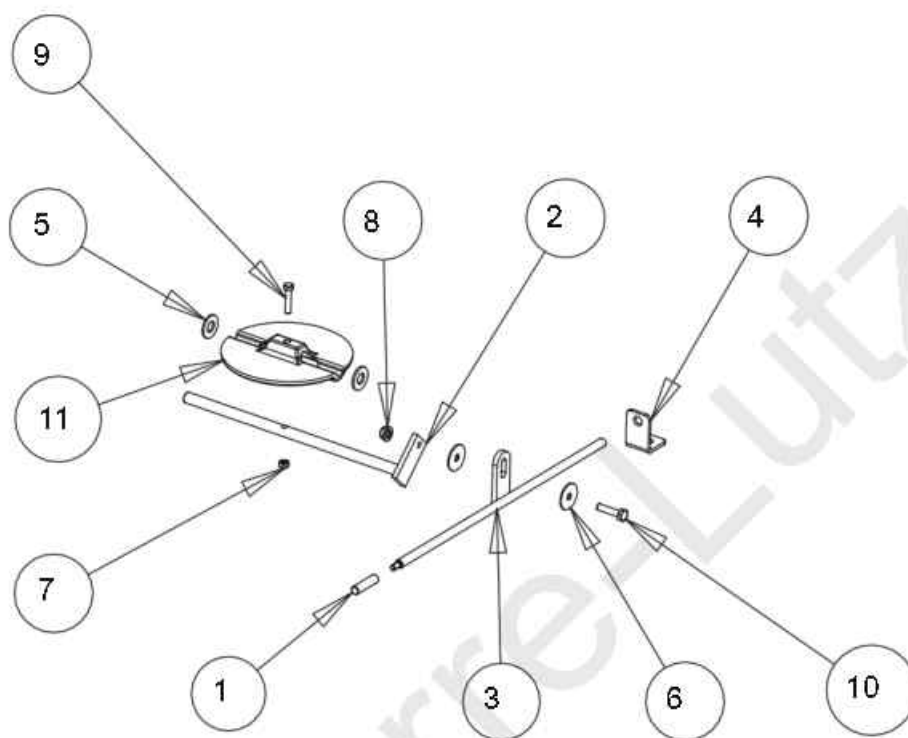

REP.	QTE	DESIGNATIONS	REFERENCES
1	1	BOUTON INOX	AS610232
2	1	AXE VOLET	AS700100
3	1	TIGE VOLET	AS700411
4	1	EQUERRE VOLET	AT700679
5	2	RONDELLE M10	AV4100100
6	2	RONDELLE M6	AV4216250
7	1	ECROU M5	AV7100050
8	1	ECROU EMBASE M6	AV7220060
9	1	VIS TH 5x25	AV8405250
10	1	VIS TH 6x30	AV8416300
11	1	VOLET	F660150B